

MAKE THE NEW WINSHIP INTRANET A BOOKMARK

Winship Intranet Login Guide for SharePoint Using Google Chrome

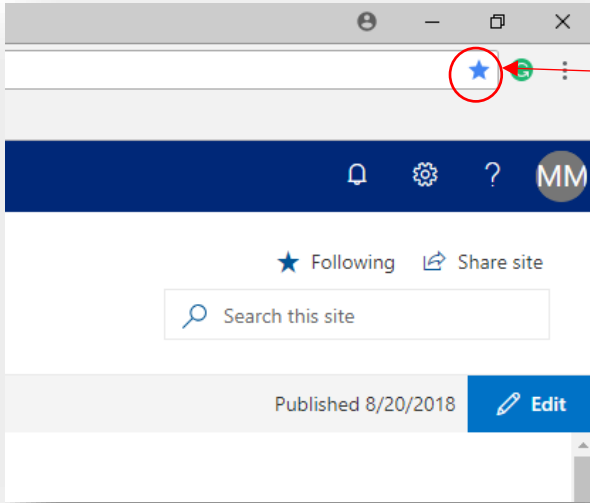

Select the "star" from the right side of the toolbar.

Enter Bookmark details. Click "Done."

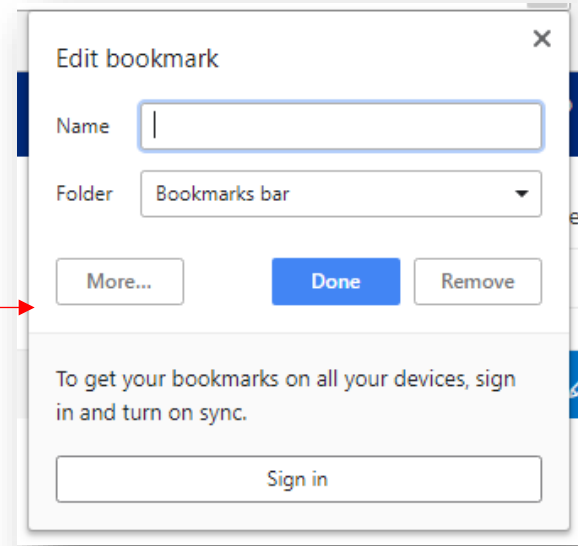

Using Firefox

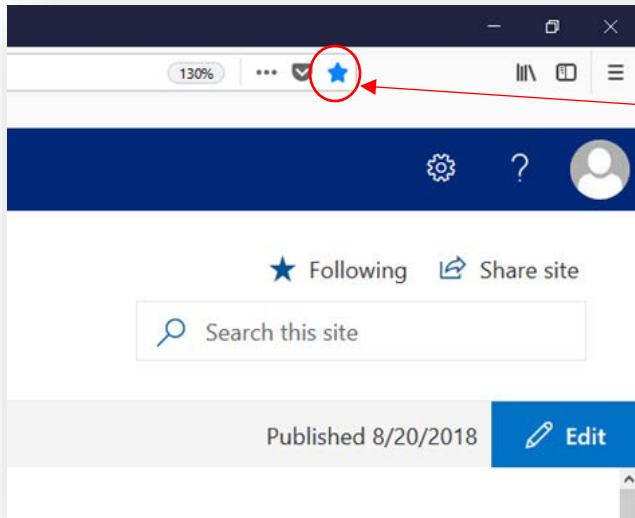

Select the "star" from the right side of the toolbar.

Enter Bookmark details. Click "Done."

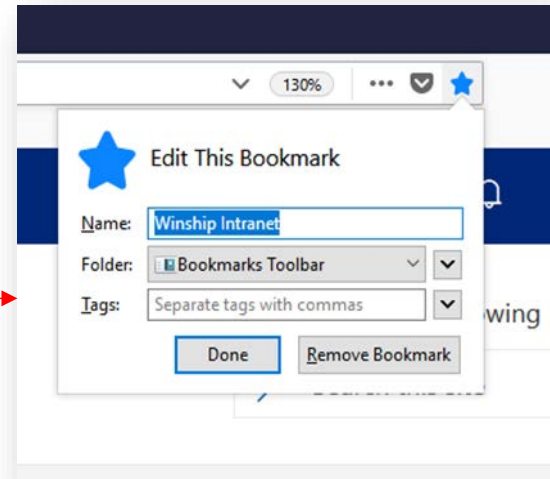

Winship Intranet Login Guide for SharePoint Using Internet Explorer

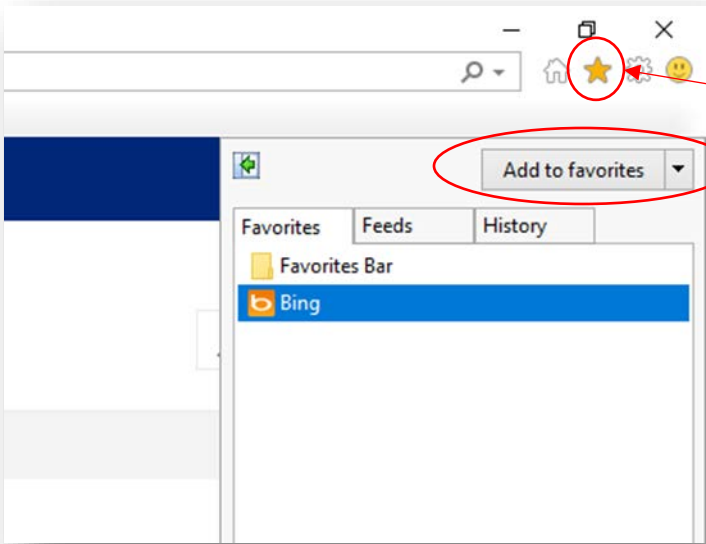

Select the "star" from the right side of the toolbar.

Click "Add to Favorites"

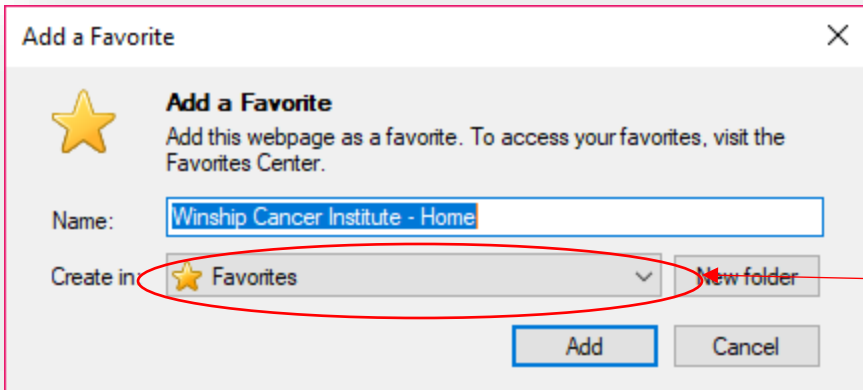

Enter Bookmark details. Click "Add."

If you would like your bookmarks in Internet Explorer to appear on the toolbar at the top of the page, select the arrow beside "Favorite" and choose "Favorites Bar." Then click "Add."

After this, hover you mouse under the address bar and right click. Select "Favorites Bar" from the menu.